

SSV-805

Color Smoke Detector Covert Camera



Specifications

Model	SSV-805
Image	
Divice	1/3" Sony CCD
Pixels(HxV)	NTSC: 510(H)*492(V)/ PAL: 500(H)*582(V)
Resolution	420 TVL
Min.Scene Illumination	
Color	0.2 Lux
B/W	N/A
Lens	
Focal Lenght	3.6mm Lens
Synchronization	
Sync. System	2:1 Interlace
S/N Ratio	
S/N Ratio	More than 48dB
Functions	
Electronic Shutter	Auto: 1/50(60) ~1/100,000 sec
Video Output	1.0 Vp-p Composite Video Output ; Ohm
Auto White Balance	Auto(2500K-9500K)
Auto Gain Control	Auto
Environmental	
Operating Temperature	- 10°C~ + 50°C degree
Power	
Power Consumption	DC 12V (-/+10%)

Feature

- Sony CCD
- 0.2 Lux / F2.0
- 3.6mm Lens
- ATW With MCT Technology (Multi-Color Temp)
- Auto Gain Control
- Auto Back Light Compensation
- DC12V

Dimension(unit:mm)

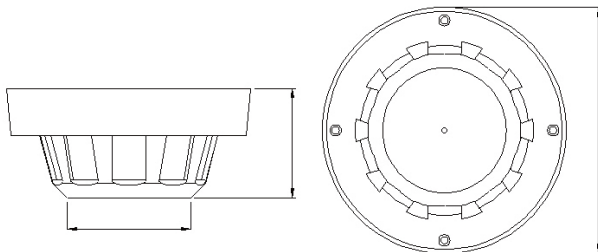

J&S United Technology Corp.
13F-6, No. 258, Lian-Cheng Rd., Chung-Ho City, Taipei County 235, Taiwan
TEL.: +886-2-8227-2528 FAX: +886-2-8227-2338
www.jsctv.com.tw

